



## Flat B 33 Canterbury Grove

London, SE27 0NX

**£1,600 Per Month**

A good size two double bedroom first-floor Victorian conversion flat offered to the market freshly decorated and with newly fitted carpets. The property has a decent-sized modern open-plan kitchen/reception room with wood flooring. The flat is double glazed throughout and has gas central heating. Situated in an ideal location for transport and shopping amenities.

Lambeth Council

Council Tax Band C £1819.66

Total Deposit £1846.15 (5 Weeks Rent)

### Viewing

Please contact our Galloways West Norwood Office on 020 8766 6111

if you wish to arrange a viewing appointment for this property or require further information

- TWO DOUBLE BEDROOMS
- FIRST FLOOR
- DOUBLE GLAZED WINDOWS
- MODERN FITTED KITCHEN
- CENTRAL HEATING
- VICTORIAN CONVERSION
- SPLIT LEVEL
- CLOSE TO AMENITIES
- 5 MINUTES WALK TO WEST NORWOOD STATION
- (ESTIMATED TIMES VIA GOOGLE MAPS)



## Floor Plan

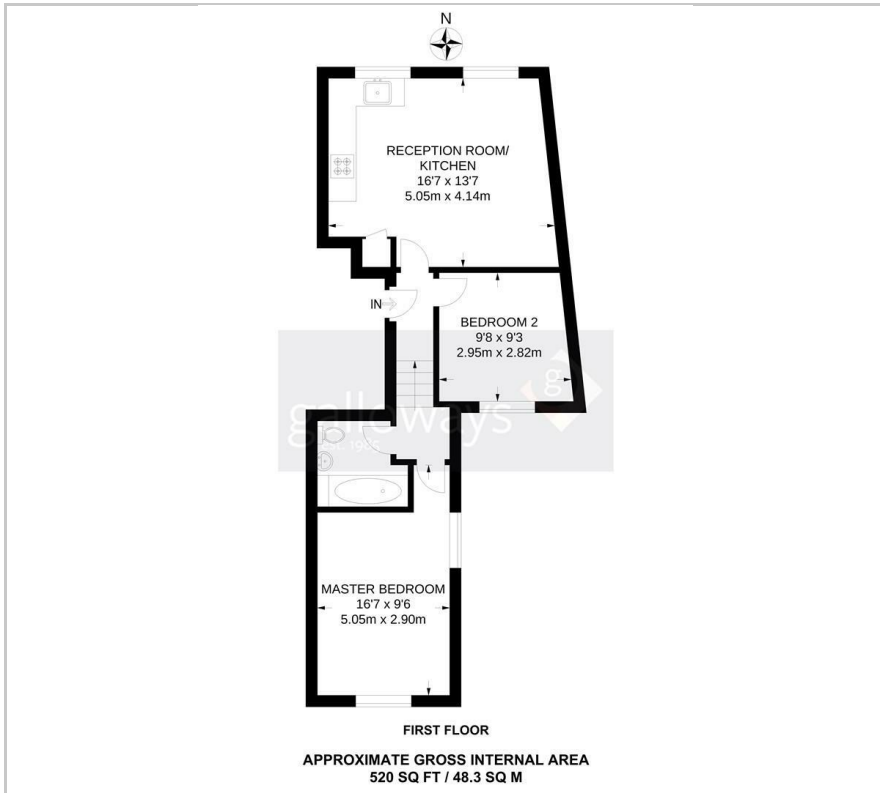

## Area Map

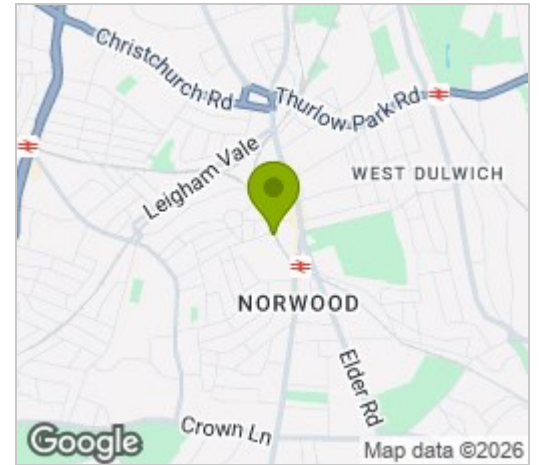

## Energy Efficiency Graph

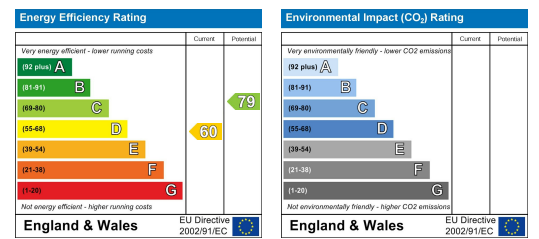

These particulars, whilst believed to be accurate are set out as a general outline only for guidance and do not constitute any part of an offer or contract. Intending purchasers should not rely on them as statements of representation of fact, but must satisfy themselves by inspection or otherwise as to their accuracy. No person in this firm's employment has the authority to make or give any representation or warranty in respect of the property.